



## HIDAYATULLAH NATIONAL LAW UNIVERSITY, NAYA RAIPUR

### ABOUT THE UNIVERSITY:

Hidayatullah National Law University (HNLU) was established under the Hidayatullah National University of Law, Chhattisgarh, Act, (No. 10 of 2003) 2003. It is recognized by the University Grants Commission u/s 2(f) and 12(B) of the UGC Act, 1956 and also by the Bar Council of India u/s 7(1) of the Advocates Act, 1961. Named after one of the great legal luminaries of India Justice Mohammad Hidayatullah, HNLU was established in May 2003 by the Government of Chhattisgarh with a view to impart and advance legal education by engaging in teaching and research, and to develop among students a sense of responsibility to serve the society in the field of law by taking to advocacy and reforms in law and justice administration system.

HNLU is sixth in the series of National Law Universities/Schools in India and is currently into the fifteen years of its existence. From a simple beginning in 2003, over the last fourteen years, HNLU has been making rapid strides to become a Centre of Excellence in legal education in the country and is in the process of transforming itself into a world class institution. Hon'ble Mr. Justice Arun Mishra, Judge, Supreme Court of India is the Visitor, Hon'ble Mr. Justice T.B. Radhakrishnan, Chief Justice, High Court of Chhattisgarh is the Chancellor and Prof. (Dr.) Sukh Pal Singh is the Vice-Chancellor of the University.

The University is located in a serene and pollution free environment spread over 65 acres of land abutting a beautiful lake on the backside, located at a distance of 28 kilometres from the city of Raipur.

### INFRASTRUCTURE:

The circular academic and administrative block has been built on the design of the Parliament of India and is fully equipped with the State-of-the-art infrastructure, modern teaching aids and equipment's important for academic pursuits. It has a unique Amphitheatre at its



Prof. (Dr.) Sukh Pal Singh  
Vice-Chancellor



Dr. Ayan Hazra  
Registrar (i/c)

center which is like the Amphitheatre of Athens (Greece). The Amphitheatre can accommodate more than 1000 people at a time and is tastefully used for cultural activities/common gatherings. It also has an air-conditioned Conference Hall having acoustic treatment and a seating capacity of 400 persons. The University has 18 air-conditioned classrooms fitted with modern teaching aids and equipment's which create a quality academic environment. It has a well-equipped and fully air-conditioned Computer Lab with internet facility. The Computer Lab is furnished with modern computer furniture / cubicles having around 200 computer terminals/ nodes.

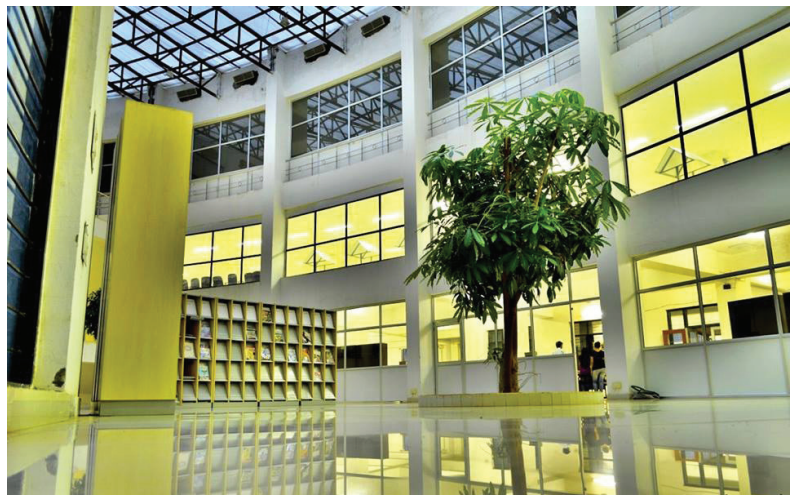

Additionally, the University provides a fully Wi-Fi enabled campus. The language lab equipped with modern gadgets and learning tools helps in improving the writing and presentation skills of the students. The university has newly constructed New Academic Block having 12 more classrooms, Women Facility Centre, Hostel for Female Research Scholars, Guest House, Canteen, Full-fledged Bank, two ATMs and Utility Centre.

#### **HALLS OF RESIDENCE:**

As a fully residential university, HNLU has separate Halls of Residence for boys and girls. In addition to the two large hostels having 400 single occupancy rooms each for boys and girls furnished with modern furniture, the University has a PG Hostel for Girls having a capacity of 20 seats. Further, there are two more new hostels constructed for both boys and girls. These two hostels, having 216 double occupancy rooms each. The hostels on campus being miniature societies, residing on campus enables students to meet people from diversified cultural background, interact with them, understand, appreciate and share each other's views and experiences. It helps widen their world view and acquire important inter-personal skills. As a 'home away from home', the campus life offers exciting experiences to students coming from various parts of the country. Further, there is provision for separate Mess and Gymnasium in both the hostels. In addition to the Gym facility

provided inside the hostels, indoor and outdoor games facilities such as table tennis, lawn tennis, badminton, basketball, volleyball, cricket and football are also available within the university campus. Medical facilities, including visiting doctor and ambulances are available in the university campus.

#### **LIBRARY:**

The University has a beautifully designed three-storied library with air-conditioned reading halls having a seating capacity of 600 students at a time. The structure of the University library is similar to the library of London School of Economics. The library has numerous modern stacks with varied and rich collection of text books, journals, reference books and periodicals. The library regularly subscribes to the useful legal databases such as *Manupatra*, *Westlaw*, *HEIN Online*, *SCC Online*, *AIR Webworld*, *LexisNexis*, *JSTOR*, etc. for the benefit of the students, research scholars and faculty members as well. It also houses environment-friendly spacious lounges which are just below the open-to-sky area protected from rain and direct sunlight by transparent polymer sheets. All day long, this area of the library is lighted by natural light. The lush green Amphitheatre visible through transparent glasses from the library creates an eco-friendly and aesthetic ambience for the library users to concentrate on and enjoy their reading. The university is operating a printing center inside the library for the benefit of the students.

#### **MOOTING:**

HNLU has a rich culture of mooting among the

students. To help, prepare and train the students in their moot exercises, the University has five State-of-the-art Moot Court Halls carefully designed to match the standards of the Supreme Court of India and the High Courts. In addition to providing a conducive and competitive environment, the university extends all possible help and financial support to the students for moot. With the financial assistance received from the Government of Chhattisgarh, the university spends Rs. 1 crore every year for participation of students in moot court competitions, seminars, conferences and workshops at the national and international level. Our students, on multiple occasions, have brought laurels to the University by showing steely talent in various prestigious moot court competitions. Further, the university has also been regularly organizing since 2007 the Justice Hidayatullah Memorial National Moot Court Competition (HNMCC) on annual basis to promote the culture of moot among the students.

#### **FACULTY MEMBERS:**

HNLU has a team of highly qualified, competent and dedicated faculty members with diverse backgrounds and areas of specialization. In addition to the classroom teaching, the faculty members also attend to the individual needs of students through mentoring and consultation. For creating high quality academic ambience so as to enable the students to strive for perfection in their academic endeavours, the university offers exhaustive, diverse and cross functional curriculum to its students both at graduate and post-graduate levels. To achieve the multifarious objectives, the University regularly organizes national and international seminars, conferences, moot court competition and special guest lectures by eminent academicians and professionals from within India and abroad. The continuous assessment of students helps in an honest evaluation of the true potential of students. The student-teacher ratio at HNLU is one of the best in the country.

#### **PLACEMENT:**

Trained in various specialized areas of law, the young law graduates from HNLU have represented themselves in every sphere and spectrum of legal

profession. In addition to practicing in law courts in the country including High Courts and the Supreme Court of India as Counselors, they are working with the corporate world, law firms and business houses as trained legal professionals in business & corporate law, International Trade Law, Investment Law, Taxation Law, Insurance Law, Intellectual Property Rights Law, Environmental Laws, etc. HNLU has created a record by placing its students through the recruitment program. The recruiters with whom our students have been working include Amarchand Mangaldas, Suresh A. Shroff & Co., Anand & Anand, Axis Bank, AZB & Partners, Bajaj Allianz, Corporate Law Group, Dave and Girish & Co., Desai and Diwanji, DSK Legal, Dua & Associates, Grant Thornton, Human Rights Law Network, ILF Advocates, IndusLaw, Iyer and Soonawala, Khaitan & Co., Lakshmikumaran & Sridharan, Vaish & Associates, Majmudar & Co., Mind Crest, Nishith Desai Associates, P&A Law Offices, Pangea 3, Price Waterhouse Coopers, Quizlex, SDD Global, Talwar Thakore and Associates, Wadia Ghandy & Co. and Zeus Law Associates etc.

The students of HNLU have also been placed in Government Organizations, NGOs, Public and Private Sector Banks, International Organizations, Academic Institutions, etc. Setting high standards in their respective fields, they have become role models for younger generation of students aspiring to pursue law as a profession.

#### **UNDER-GRADUATE PROGRAM**

##### **[B. A. LL. B. (HONS.)]**

##### **Eligibility:**

The eligibility is as per CLAT- 2018 Notification.



## Intake and Reservation

The intake capacity for the B.A.LL.B.(Hons.) Programme shall ordinarily be 180 (One Hundred and Eighty) with the following reservations. However, it shall be at the discretion of the Vice Chancellor to proportionately increase/decrease the total number of seats:

Category	No. of Seats (All India)	No. of Seats (Domicile of Chhattisgarh)
Scheduled Caste	12 (15%)	10 (12%)*
Scheduled Tribe	06 (7.5%)	26 (32%)*
OBC	-	11 (14%)*
Unreserved Category	62	33
<b>Total</b>	<b>80</b>	<b>80</b>
	<b>160 (One Hundred Sixty)</b>	

Note \*As per 'The Chhattisgarh Educational Institutions (Reservation in Admission) Act, 2012.

- 5% seats shall be reserved horizontally for Specially Abled Persons (SAP) at the all India level according to The Rights of Persons with Disabilities Act, 2016.
- 3% seats shall be jointly reserved for the Specially Abled Persons (SAP) and Dependents of Freedom Fighters (DFF) category of candidates belonging to the State of Chhattisgarh only. In providing horizontal reservation to the CG Domicile SAP and DFF Candidates, as per the Guidelines issued by the Directorate of Higher Education, Government of Chhattisgarh, a joint Merit List of SAP and DFF candidates will be made after adding 10% additional marks in the marks obtained by the SAP candidate only in CLAT-2018. Thereafter, the allotment of seats will have to be made horizontally from the joint Merit list of SAP and DFF candidates.
- If a Chhattisgarh domicile candidate qualifies for admission in the regular merit under all India category, he/she shall be considered against the All India seat only and not against Chhattisgarh domicile seats.

- The allotment of seats to various CG Domicile category candidates will be made as per the Guidelines issued by the Government of Chhattisgarh from time to time.
- 30% seats shall be reserved horizontally for female candidates across all categories of seats.

## NRI / NRI Sponsored and Foreign National Category Seats:

Sl.No.	Category	Seats
1.	NRI/NRI Sponsored	16
2.	Foreign Nationals	4

**Note:** For details regarding admission under Foreign National, NRI/NRI Sponsored and the Supernumerary seats for the Wards of Kashmiri Migrants and Students from Jammu & Kashmir, please visit the University website: [www.hnlu.ac.in](http://www.hnlu.ac.in). The candidates seeking admission under the Foreign National category will be required to apply directly to HNLU as per Admission Notification to be posted on the University website in May 2018. However, the candidates seeking admission under the NRI/NRI Sponsored category and Supernumerary seats for the Wards of Kashmiri Migrants & Students from Jammu & Kashmir will have to apply for and appear in CLAT-2018 under the respective categories. After the publication of CLAT-2018 Result, the interested and eligible candidates applied for and appeared in CLAT-2018 under the NRI/NRI Sponsored and Supernumerary seats for the Wards of Kashmiri Migrants and Students from Jammu & Kashmir will be required to apply to HNLU in the prescribed format to be posted on the university website in the first week of May 2018 with their CLAT Score/Rank and other required information and documents.

## Supernumerary Quota:

Sl.No.	Category	Seats
1.	Wards of Kashmiri Migrants	5
2.	Students from Jammu & Kashmir	2
3.	Increasing Diversity by Increasing Access Students (IDIA Students) <b>(See Note)</b>	



**Note:** As per the decision taken in the joint meeting of General Council and Executive Council of the University dated 22.08.2015 the IDIA students admitted to HNLU may be granted waiver of fees, treating their admission under supernumerary quota. Waiver of fees is to be granted in accordance with the rules/practice being followed by other NLUs for the purpose. The number of IDIA student to be admitted and the extent of their fee waiver is subject to the final decision to be taken by the Executive Council and the General Council. IDIA (Increasing Diversity by Increasing Access) details are available on IDIA website i.e. [www.idialaw.com](http://www.idialaw.com).

#### Fee Structure for B.A. LL. B. (Hons.) (Annual Fees)

Particulars of Fees	Amount of Fees
Admission Fee (One Time)	Rs. 5,000/-
	US \$ 1000 for NRI/NRI Sponsored Candidates & Foreign Nationals
Tuition Fee	Rs. 95,000 Indian Nationals
	US \$ 4750 for NRI/NRI Sponsored Candidates
	US \$ 6531 for Foreign Nationals
Library Fees	Rs. 7,500
Halls of Residence Charges	Rs. 12,000
Internet Charges	Rs. 5,000

Campus Devt. Charge	Rs. 5,000
Charges for Students' Activities	Rs. 3,000
Students' Welfare Fund	Rs. 1,500
Medical Fee	Rs. 2000
Electricity Charges	Rs. 6000
Examination Fee	Rs. 4000
Transportation Charges	Rs. 4000
Caution Money (Refundable)	Rs. 25,000/- (One-Time)
<b>Total</b>	<b>Rs. 1,75,000/-* (Rs. One lac seventy five thousand only)</b>

Note: \*Total amount of fees to be paid by an Indian national at the time of admission. The NRI/ NRI Sponsored Candidates will have to pay USD 5750/- plus Rs. 75000/- and the Foreign Nationals will have to pay USD 7531 plus Rs. 75,000/-.

- Mess Fee Rs.13,180/- shall be payable separately by the students on, semester basis.
- The abovementioned fees are provisional and subject to revision from time to time by the university authorities.

#### COURSE STRUCTURE:

The Five-Year Integrated B.A.LL.B.(Hons.) Program offered by the University is in complete conformity with the Bar Council of India Guidelines.

Semester – I		Semester – II	
Sl. No.	Title of The Paper	Sl. No.	Title of The Paper
1	One Major Paper*	1	One Major Paper*
2	Two Minor Papers*	2	Two Minor Papers*
3	Legal English / English Literature	3	English Literature / Legal English
4	Legal Method	4	Law of Contract-II
5	Law of Contract-I	5	Family Law-I
Semester – III		Semester – IV	
1	One Major Paper*	1	One Major Paper*
2	Two Minor Papers*	2	CG - II
3	Law of Torts	3	Labour Law - I
4	Family Law-II	4	Environmental Law
5	CG – I	5	TPA
		6	Public Intl. Law
Semester – V		Semester – VI	
1	One Major Paper*	1	One Major Paper*
2	Labour Law - II	2	Jurisprudence - II
3	Jurisprudence - I	3	Corporate Law - II
4	Corporate Law - I	4	IPR
5	Principles of Taxation Law	5	Administrative Law
6	Indian Penal Code	6	ADR
Note: * While Political Science is taught as major paper from Semester I to VI, Economics & Sociology are taught as minor papers for the first three semesters.			
Semester – VII		Semester – VIII	
1	Criminal Procedure Code	1	Land Laws
2	Law of Evidence	2	DPC
3	Honours-I P1	3	Honours-1 P2
4	Honours-II P1	4	Honours-2 P2
5	Optional-P1	5	Optional-P2
Semester – IX		Semester – X	
1	Civil Procedure Code	1	Professional Ethics
2	Honours-I P3	2	Honours-I P4
3	Honours-II P3	3	Honours-II P4
4	Optional-P3	4	Optional – P5
5	Optional-P4	5	Optional – P6

### List of Optional Papers\*

Sl. No.	Title of The Paper	Sl. No.	Title of The Paper
1	Biotechnology and Law	12	International Space Law
2	Competition Law	13	Law and Tribes
3	Corporate Tax	14	Law of Infrastructure
4	Criminology & Penology	15	Law of Insolvency
5	Cyber Law	16	Law of Insurance
6	Direct Tax	17	Law of Mines and Industries
7	Human Rights	18	Maritime Law
8	Good Governance	19	Media and Law
9	Indirect Tax	20	Medicine and Law
10	ICA	21	W.T.O.
11	International Criminal Law	22	Women and Law

\* The optional paper will be offered subject to the availability of faculty having such specializations. The University reserves the right to increase/decrease the number of optional papers.

\* Each student must opt six different optional papers during his five years B.A.LL.B.(Hons.) course.

### List of Honours Papers

Sl. No.	Title of The Paper	Sl. No.	Title of The Paper
1	Constitutional Law	4	Intellectual Property Rights
2	Corporate Law	5	Environmental Law
3	Trade and Investment Law	6	Criminal Law

### ONE-YEAR POST-GRADUATE PROGRAM (LL. M.)

HNLU offers one-year LL. M. Program spread over three trimesters. The LL.M. program is designed to inculcate research skills and analytical abilities in students. In addition to classroom training imparted through innovative teaching methods, the LL. M. Program is focused on self-learning and research conducted by the students under the guidance of the faculty members.

**Eligibility:**

The eligibility is as per CLAT- 2018 Notification.

**Intake and Reservation:**

The intake capacity for the LL.M. Programme shall ordinarily be 45 (Forty Five) with the following reservations. However, it shall be at the discretion of the Vice Chancellor to proportionately increase/ decrease the total number of seats:

Sl.No.	Category (All India)	No. of Seats
1.	Scheduled Caste (15%)	07
2.	Scheduled Tribe (7.5%)	03
3.	Unreserved Category	35
<b>Total</b>		<b>45 (Forty Five)</b>

**Note:**

- 5% seats shall be reserved horizontally for Specially Abled Persons (SAP).
- 30% seats shall be reserved horizontally for female candidates across all the categories of seats.

**Additional Seats**

Sl. No.	Category	Seats
1.	Supernumerary Seats for the Wards of Kashmiri Migrants	02
2.	Students from Jammu & Kashmir	02

**Fee Structure for LL. M. Program (Annual Fees)**

Particulars of Fees	Amount of Fees
Admission Fee	Rs. 5,000 (One-Time)
Tuition Fee	Rs. 35,000
Library Fees	Rs. 7,500
Halls of Residence Charges	Rs. 12,000
Internet Charges	Rs. 5,000
Campus Development Charge	Rs. 5,000
Students' Welfare Fund	Rs. 2,000
Transportation Charges	Rs. 4,000
Medical Fee	Rs. 2,000

Electricity Charges	Rs. 6000
Examination Fee for thesis evaluation	Rs. 10,000 (One-Time)
Caution Money (Refundable)	Rs. 10,000/- (One-Time)
<b>Total</b>	<b>Rs. 1,03,500/- * (Rs. One Lac Three Thousand Five Hundred only)</b>

Note: \* Total amount of fees to be paid by a candidate at the time of admission.

- Mess Fee Rs.15,816/- shall be payable separately for every six month.
- The fees are provisional and subject to revision from time to time by the university authorities.

**COURSE STRUCTURE:**

As per the UGC Guidelines dated 18<sup>th</sup> January 2013 regarding introduction of one-year LL.M. Program, HNLU has adopted the one-year LL.M. Program from the Academic Session 2013-14. It follows a trimester system wherein following courses are taught in different trimesters.

First Trimester	
Sl. No.	Title of The Paper
1	Core Course: Research Methods and Legal Writing
2	Core Course: Comparative Public Law/ Systems of Governance
3	Core Course: Law and Justice in a Globalizing World
4	Optional Course: Paper-I
Second Trimester	
1	Optional Course: Paper - II
2	Optional Course: Paper - III
3	Optional Course: Paper - IV
4	Optional Course: Paper - V
Third Trimester	
1	Optional Course: Paper - VI
2	Dissertation
3	Viva-Voce

### Specializations Offered in LL. M. Program

1. Corporate Law
2. Intellectual Property Rights Law
3. Environmental Law

The optional courses will be offered subject to the availability of faculty and a minimum number of students opting for such specializations. The University reserves the right to increase/decrease the number of specialization in LL.M. programme.

### Ph.D. PROGRAM IN LAW

Ph.D. Program in Law has commenced at HNLU w.e.f. academic session 2014-15 wherein admission of research scholars is made strictly based on entrance test conducted by the University separately. The intake to Ph.D. program is 30.

#### Availability of Scholarships:

Students belonging to SC, ST and OBC category are provided with scholarships from the Government of India and Chhattisgarh. Further, the students belonging to SAP and Minority Communities are also provided with scholarship under various Government Schemes.



**For further details, contact:**

**Registrar**

**Hidayatullah National Law University**

Naya Raipur – 492002 (Chhattisgarh)

Phones: 0771-3057603, 3057604

For Query regarding admission: 0771-3057604, 3057617

Tele/Fax: 0771-3057666

E-mail: registrar@hnl.ac.in, Website: www.hnl.ac.in

---